

29U — BOLTS AND NUTS FOR MECHANICAL JOINTS

Revised 02/2025 (Current revisions for the noted Standards apply)

SIZES:	5/8 x 3 through 1-1/4 x 8-1/2.
STANDARDS:	ANSI/AWWA C111/A21.11.
MATERIAL:	ASTM A242 high-strength low-alloy steel. Also available in ANSI 304 or ANSI 316 AISI Stainless Steel.
COATING:	Standard nuts and bolts are not coated. Flouropolymer coating is available upon request. Flouropolymer is Fluorokote #1 (blue for low alloy steel).
FASTENERS:	High-strength low-alloy weathering steel per ANSI/AWWA C111/A21.11 and ASTM A242.

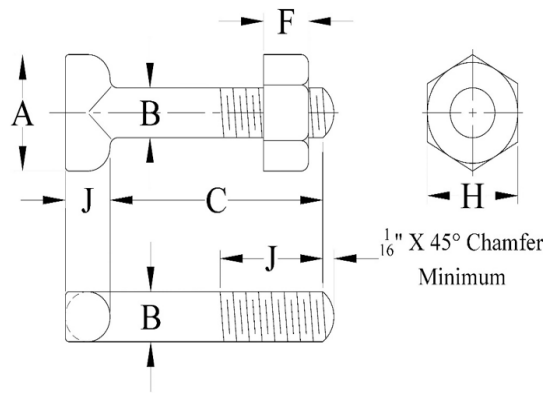

NOMINAL JOINT DIMENSIONS IN INCHES

Size (In.)	A ± 0.05	B +0.03 / -0.074	C +0.25 / -0.06	F	H	J +0.15 / -0.03	R Max	D*	Threads Per Inch E**
5/8 x 3	1.5	0.625	3.00	0.625	1.062	0.625	0.312	2.00	11
3/4 x 3-1/2	1.75	0.750	3.50	0.750	1.250	0.750	0.375	2.50	10
3/4 x 4	1.75	0.750	4.00	0.750	1.250	0.750	0.375	3.00	10
3/4 x 4-1/2	1.75	0.750	4.50	0.750	1.250	0.750	0.375	3.00	10
3/4 x 5	1.75	0.750	5.00	0.750	1.250	0.750	0.375	3.00	10
1 x 6	1.75	1.000	6.00	1.000	1.625	1.000	0.500	3.00	8
1 x 7-1/2	2.25	1.000	7.50	1.000	1.625	1.000	0.625	4.50	8
1-1/4 x 6-1/2	2.50	1.250	6.50	1.250	2.000	1.250	0.750	3.50	7
1-1/4 x 8-1/2	2.50	1.250	8.50	1.250	2.000	1.250	0.750	4.00	7

NOTES:

- Dimension B is unthreaded shank.
- Draft, when required to be 6° maximum, may be deducted from bolt head dimensions, and radius may be changed to suit draft.
- Gates, if required, may protrude a maximum of 1/8" above the top of the bolt head.
- Chamfer is optional if threads are rolled.
- If threads are rolled, the body diameter may be reduced to the approximate pitch diameter of the thread.

Note: Tolerance +3/-0 thread.

Note: Number of threads per inch — coarse-thread series (ANSI/ASME B1.1), class 2A, external fit UNC2A and class 2B, UNC2B (ANSI/ASME B1.2).

(3) If seal coat paint is used during field repair, allow a cure time of 48 hours after the seal coat is applied before placing fitting back in service.